

SIROKKO
HOT AIR GENERATORS

GAS AIR HEATER USER MANUAL

Dear our valued customers,

Our company, which was established to provide expectations and needs, offers you the latest technology devices for your comfort and convenience.

Before starting up the heater, carefully read this user manual, which contains basic information for correct and safe installation and maintenance.

This guide is part of the product. Keep this manual for future reference.

Products

The products introduced in this manual are listed in the table below

PRODUCT TYPE	HEAT POWER
SIROKKO 20	17.3 kW
SIROKKO 30	27.2 kW
SIROKKO 40	36.7 kW
SIROKKO 50	47.5 kW
SIROKKO 60	57 kW
SIROKKO 70	66.5 kW

Warranty

Dear user; Sirokko model warm air heater is produced by PANERA Müh. Mak. İml. San. Tic. Ltd. Şti. It is under warranty starting from the date of purchase. The warranty conditions cover manufacturing faults. Faults and problems caused by the user or external factors are not covered by the warranty.

CONTENTS

MAIN SAFETY RULES	4
INSTALLATION SCHEMES AND DIMENSIONS	5
INSTALLATION PLACES	6
EXHAUST GAS AND COMBUSTOR OPTIONS	8
INSTRUCTIONS FOR THE USER.....	13
TECHNICAL SPECIFICATIONS	14
LABELS AND SCHEMATIC DIAGRAM.....	15
MALFUNCTION AND SERVICE	16



▶ MAIN SAFETY RULES

- SIROKKO heater is only designed to heat the area where it is used. Do not use it for any other purpose.
- Do not install and operate the unit if the cable, plug or glass surface of your heater are damaged.
- If the electrical components are damaged, only the authorized service can intervene.
- This device cannot be used by people (including children) with reduced physical, sensory or mental abilities or lack of experience and knowledge, unless they are supervised or trained on the use of the unit by the person who is responsible for its safety.
- Make sure that children do not play with the device.
- Do not let the plug, cable or device itself approach or contact to water or any liquid to avoid fire, shock or injuries.
- The heater should not be installed outdoors. The heater must be installed in a safe location and on a solid surface against impacts and falling.
- Check that the socket where you will plug the heater is grounded and that the voltage is 220-240 volts.
- The power cable must not contact the body of the device. Also, install the device in such a way that it does not heat the electrical cable and plug.
- If the heater is used for a long time, the body parts will reach high temperature. In this case, do not touch the device.
- No object should be placed and covered over the device
- Do not operate the heater near flammable materials such as oil and solvents
- Mount your device parallel to the ground.
- Install the hermetic chimney outlet of the device, taking into account the following warnings.

▶ INSTALLATION SCHEMES AND DIMENSIONS

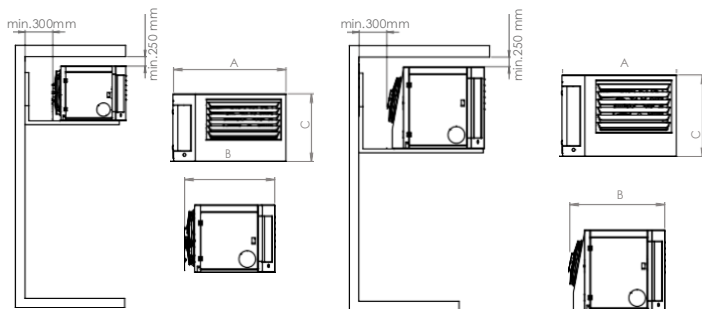

PRODUCT	AxBxC (mm)
SIROKKO 20	885x450x760
SIROKKO 30	885x490x760
SIROKKO 40	885x530x760

PRODUCT	AxBxC (mm)
SIROKKO 50	950x885x810
SIROKKO 60	1185x885x850
SIROKKO 70	1185x885x850

▶ **INSTALLATION PLACES**

Model	Unit	SIROKKO 20	SIROKKO 30	SIROKKO 40
Length (A)	(mm)	885	885	885
Height (B)	(mm)	450	490	530
Width (C)	(mm)	760	760	760
Weight	(kg)	55	60	65

Model	Unit	SIROKKO 50	SIROKKO 60	SIROKKO 70
Length (A)	(mm)	950	1185	1185
Height (B)	(mm)	885	885	885
Width (C)	(mm)	810	850	850
Weight	(kg)	97	145	145

The grill will be closed when the device is delivered.

Before operating, adjust it in the desired direction as at least 45° as shown in the picture.

Example of installation when the device is placed in small areas

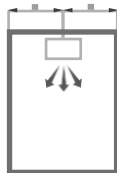

Example of installation when the device is placed in average areas

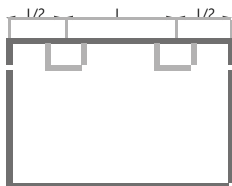

Example of installation when the device is placed in large areas

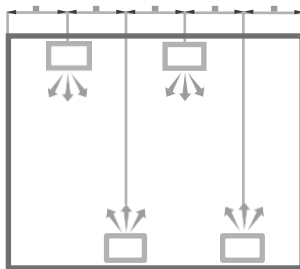

▶ EXHAUST GAS AND COMBUSTOR OPTIONS

B₂₂

SET-UP DIAGRAM: EXHAUST GAS OUTLET FROM THE WALL AND FRESH AIR INLET FROM INSIDE THE ROOM

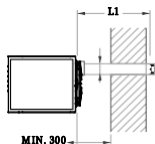

B₂₂

SET-UP DIAGRAM: EXHAUST GAS OUTLET FROM THE ROOF AND FRESH AIR INLET FROM INSIDE THE ROOM

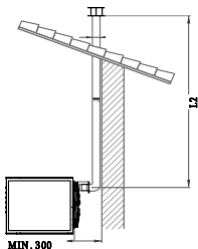

EXHAUST GAS DUCT DIMENSIONS TABLE

Model	Unit	Exhaust Gas Outlet from the wall		Exhaust Gas Outlet from the roof	
		L1 min	L1 max	L2 min	L2 max
Sirokko 20	meter	1	10	1	10
Sirokko 30	meter	1	10	1	10
Sirokko 40	meter	1	10	1	10

Important Notes

- Only use the accessories provided by the manufacturer in the exhaust gas and combustion air suction ducts.
- Do not allow any condensate, if it occurs, in the exhaust gas duct to enter the hot air generator.
- Place a condensate drain at the lowest point of the duct.
- Each elbow corresponds to approximately 0.8 - 1.0 meters of straight length.

C₁₂

SET-UP DIAGRAM: EXHAUST GAS OUTLET AND COMBUSTION AIR SUCTION WITH CONCENTRIC DUCT FROM THE WALL

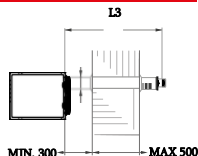
B₂₂

SET-UP DIAGRAM: EXHAUST GAS OUTLET AND COMBUSTION AIR SUCTION WITH CONCENTRIC DUCT FROM THE ROOF

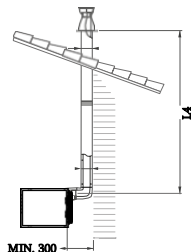

EXHAUST GAS AND COMBUSTION AIR SUCTION DUCT DIMENSIONS TABLE

Chimney diameter: 80mm-125mm

Model	Unit	CONCENTRIC DUCT FROM THE WALL		CONCENTRIC DUCT FROM THE ROOF	
		L3 min	L3 max	L4 min	L4 max
Sirokko 20	meter	1	8	1	8
Sirokko 30	meter	1	8	1	8
Sirokko 40	meter	1	8	1	8

Important Notes

- Only use the accessories provided by the manufacturer in the exhaust gas and combustion air suction ducts.
- Do not allow any condensate, if it occurs, in the exhaust gas duct to enter the hot air generator.
- Place a condensate drain at the lowest point of the duct.
- Each elbow corresponds to approximately 0.8 - 1.0 meters of straight length.

B₂₂

SET-UP DIAGRAM: EXHAUST GAS IS THROWN OUT FROM THE BUILDING AND COMBUSTION AIR IS PROVIDED FROM INSIDE THE ROOM

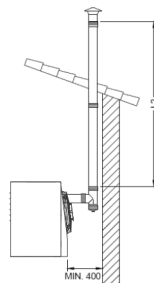
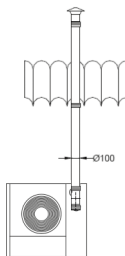
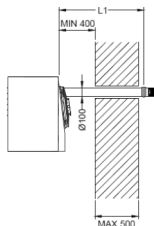

Model	Unit	HORIZONTAL EXHAUST GAS PIPE LENGTH		VERTICAL EXHAUST GAS PIPE LENGTH	
		L1 min	L1 max	L2 min	L2 max
Sirokko 50	meter	1	5	1	10
Sirokko 60	meter	1	5	1	10
Sirokko 70	meter	1	5	1	10

Important Notes

- Only the accessories provided by the manufacturer can be used in the installation.
- If there is a risk of condensation in the fume pipes, it should be considered to place a drain.
- Each elbow corresponds to approximately 0.8 - 1.0 meters of straight length.
- Sufficient gap must be provided for combustion air and ventilation.

C₁₂**SET-UP DIAGRAM:**

HORIZONTAL CONCENTRIC
EXHAUST GAS RELEASE AND
HORIZONTAL INDEPENDENT
FLUE KIT

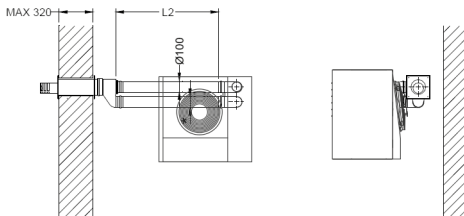
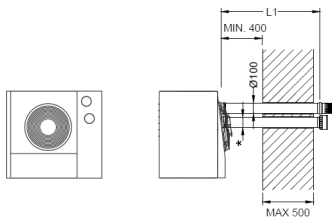

Model	Unit	HORIZONTAL EXHAUST GAS PIPE LENGTH		VERTICAL EXHAUST GAS PIPE LENGTH	
		L1 min	L1 max	L2 min	L2 max
Sirokko 50	meter	1	2.5	1.5	2.5
Sirokko 60	meter	1	2.5	1.5	2.5
Sirokko 70	meter	1	2.5	1.5	2.5

Important Notes

- Only the accessories provided by the manufacturer can be used in the installation.
- If there is a risk of condensation in the fume pipes, a condensate drain should be placed.
- Each elbow corresponds to approximately 0.8 – 1.0 meter of straight length.
- Sufficient gap must be provided for combustion air and ventilation.

C₃₂

**SET-UP DIAGRAM: VERTICAL
CONCENTRIC EXHAUST GAS RELEASE
ROOF TERMINAL INSTALLATION,
COMBUSTION AIR IS TAKEN FROM
OUTSIDE OF THE BUILDING**

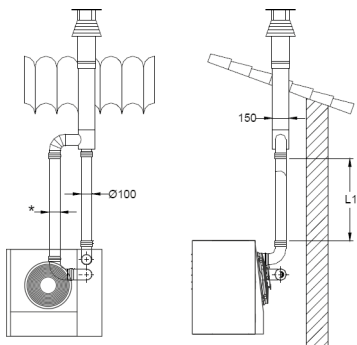

Model	Unit	VERTICAL EXIT ROOF TERMINAL	
		L1 min	L1 max
Sirokko 50	meter	0	10
Sirokko 60	meter	0	10
Sirokko 70	meter	0	10

Important Notes

- Only the accessories provided by the manufacturer can be used in the installation.
- If there is a risk of condensation in the fume pipes, a condensate drain should be placed.
- Each elbow corresponds to approximately 0.8 – 1.0 meter of straight length.
- Sufficient gap must be provided for combustion air and ventilation.

▶ INSTRUCTIONS FOR THE USER

- Gas connection is carried out after the device is solidly and properly assembled.
- A socket must be installed at a point where the electrical cord of the device can reach.
- A fuse box should be created to control the sockets.
- Ignition starts when the device gives a start command from the remote.
- To turn off the device, only press the on-off button on the remote instead of pulling out the plug.
- To operate the device, also press the on-off button.
- When the room thermostat input is connected, the device should be open from the remote control and indicator lights should be active.
- Use the reset button to restart the device only when any anomaly reports indicated by the lamps.

Remote Control Panel



- ⏻ On-Off
- R Reset
- 1 1. Stage Isitma
- 2 2. Stage Isitma
- F Function: Turns off the heater, only turns on the fan.

Room Thermostat Connection



When the cover is opened, remove the short-circuit cable connected to the terminal inside and connect the room thermostat ends to the two ends of the terminal.

▶ TECHNICAL SPECIFICATIONS

Model	Unit	SIROKKO 20		SIROKKO 30		SIROKKO 40		SIROKKO 50	SIROKKO 60	SIROKKO 70
		1 st Stage	2 nd Stage	1 st Stage	2 nd Stage	1 st Stage	2 nd Stage			
Nominal Thermal Power	(kW)	10,4	17,3	16,4	27,2	22,1	36,7	47.5	57	66,5
Output Power	(kW)	9,6	16	15,1	25	20,4	34	43	51,5	60
Natural Gas Consumption	(Nm ³ /hr)	1,1	1,81	1,7	2,84	2,3	3,83	5	5	7,5
Gas Connection	(inch)	1/2"	1/2"	1/2"	1/2"	1/2"	1/2"	1/2"	3/4"	3/4"
Inlet Pressure	(mbar)	LNG (max:50/min:20) - LPG (max: 50/min: 30)								
Power Supply	(volt)	230v, 50Hz								
Air Flow	(m ³ /hr)	2600		2600		3500		4800	5960	5960
Power	(W)	170		170		210		250	276	276
Fan Diameter	(mm)	350		350		400		450	350x2	350x2
Noise Level	(dBA)	52		52		53		53	52	52
Length (A)	(mm)	885		885		885		950	1185	1185
Height (B)	(mm)	450		490		530		885	885	885
Width (C)	(mm)	760		760		760		810	850	850
Weight	(kg)	55		60		65		97	145	145
Heating Area	(m ²)	60-120		80-150		150-225		200-400	250-500	325-650

Table values are approximate. They might be variable according to atmospheric conditions like indoor space, isolation and airflow.

Recommended safe distance might be changed according to space conditions and location under the supervision of Panera.

▶ LABELS AND SCHEMATIC DIAGRAM

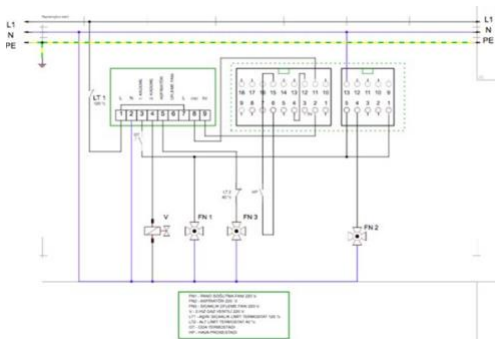

PANERA MÜHENDİSLİK MAKİNA İMALAT SANAYİ TİCARET LTD. ŞTİ.

Fevzi Çakmak Mahallesi Kobisan Sanayi Sitesi 10758
Sk No:9/D Karatay / Konya / TÜRKİYE
Tel: +90 332 346 12 34 Fax: +90 332 346 01 23
Web: www.paneramakina.com.tr
Mail: info@paneramakina.com.tr

Cihaz tanımı	DIŞ MEKAN ISITICI
Model	
Tip	
Qn kW (Hi)	
Σ Qn kW (Hi)	
Seri no	
Üretim tarihi	
Product ID No	
CAT	
	
G20-20 mbar	

TR

Servis yapmadan önce cihazın bağlantısını kesiniz. Bu bölüm, sadece yetkili servis teknisyeni tarafından açılmalıdır.

GB

Disconnect before servicing. This enclosure must only be opened by a qualified service technician.

▶ MALFUNCTION AND SERVICE

PLEASE CONSIDER THE FOLLOWING ISSUES BEFORE CALLING TECHNICAL SERVICE.

- Check the electrical connections. Call an electrician if the socket is not working.
- Make sure that the required pressure is in the gas line. If not, please contact your natural gas supplier.
- If the error lamp is on and the device does not work even though you press the reset button, contact the technical service.
- It does not require any spare parts other than the parts on the device. Do not install parts from outside except the authorized service.
- For repairs within the scope of warranty, contact the authorized service.
- Specifications and this manual are subject to change without notice.

The place of manufacture:

PANERA MÜHENDİSLİK MAKİNA İMALAT SANAYİ TİCARET LTD. ŞTİ.

Fevzi Çakmak Mahallesi Kobisan Sanayi Sitesi 10758 Sk No:9/D Karatay / Konya / TÜRKİYE

Manufacturing company:

PANERA MÜHENDİSLİK MAKİNA İMALAT SANAYİ TİCARET LTD. ŞTİ.

Fevzi Çakmak Mahallesi Kobisan Sanayi Sitesi 10758 Sk No:9/D Karatay / Konya / TÜRKİYE

Tel: +90 332 346 12 34

Fax: +90 332 346 01 23

Web: www.panera.com.tr

Mail: info@panera.com.tr

Warranty

Manufacturing Company

Name	PANERA MÜHENDİSLİK MAKİNA İMALAT SANAYİ TİCARET LTD. ŞTİ.
Address	Fevzi Çakmak Mahallesi Kobisan Sanayi Sitesi 10758 Sk No:9/D Karatay / Konya / TÜRKİYE
Phone	+90 332 346 12 34
Mail	info@panera.com.tr

Product

Type	
Brand	
Model	
Delivery Date	
Max. Repair Time	
Guarantee Period	

Vendor

Name	
Address	
Phone	
Date-Sign-Stamp	

This document is valid from the delivery date until the warranty period only together with a copy of invoice.

PANERA

Müh. Mak. İml. San. ve Tic. Ltd. Şti.

www.paneramakina.com.tr



PANERA MÜHENDİSLİK MAKİNA İMALAT SANAYİ TİCARET LTD. ŞTİ.
Fevzi Çakmak Mahallesi Yakamoz Caddesi No:10 Karatay/Konya/TÜRKİYE
Tel: +90 332 346 1234 • Faks:+90 332 346 0123 • E-Mail: info@paneramakina.com.tr